

NetBrain Problem Diagnosis Automation Business Value

Hybrid Cloud-Connected networks must deliver the IT services needed by the business with the right level of connectivity, performance and security control, while minimizing the cost and risk of doing so. According to Gartner, “the limited network automation in most enterprises creates bottlenecks in provisioning, and in incident resolution, while increasing the likelihood of human errors.”¹ Network teams are understaffed, and according to Enterprise Management Associates, “more than 78% of IT professionals agree that network automation tools can mitigate that challenge.”²

What is NetOps looking to do?

- Reduce the cost of network operations, increase the responsiveness to the business
- Reduce the risk of network outages due to human error, and configuration drift
- Assure that their networks directly support their critical applications and services
- Reduce the duration of service outage and performance degradations
- Reduce incident service ticket volume and the frequency of escalations
- Better leverage previous experience, subject matter expertise, and collaboration across teams

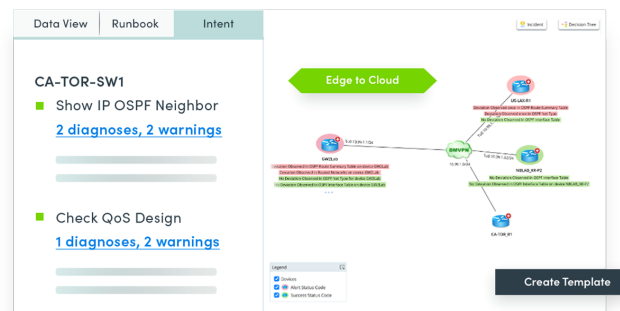

What NetBrain will do for you:

- Lower the cost of network operations and the risk to the business
- Increase the utilization of available resources
- Increase application uptime and availability
- Uphold brand reputation, customer satisfaction and valuation

The NetBrain Difference:

- Focuses on service delivery, not the health of network devices, by using Intents to assure the network is delivering business outcomes at a cost that is in line with business needs.
- Addresses Day-2, or ‘everyday’, network operations rather than configuration and deployment only.
- Enables any level engineer to easily define and use network intents and perform advanced diagnostics without the need for code.
- Includes pre-built intents as automation in an out-of-the-box library that any user can draw from regardless of their own personal experience level.
- Automatically generates network intents to diagnose all similar incidents across any hybrid global network infrastructure at scale.
- Integrates intents in maps and paths for visual troubleshooting and enables collaborative troubleshooting to reduce MTTR.
- Protects the entire network during change management by verifying existing applications, traffic flows, and the network components they rely on are in place after changes are made.
- Assures application availability and service levels by continuously verifying that performance conditions needed remain in place.

NetBrain is Strategic

NetBrain’s Problem Diagnosis Automation System (PDAS) is the industry’s only no-code network operations platform specifically designed to address the cost structure of Day-2 operations at scale. While other solutions focus on managing individual devices, NetBrain describes and manages a set of network design intents to meet the needs of the business. Network intents describe the required connectivity, performance and security profiles for the network as defined by each of the organization’s applications. This prevents service outages and performance degradations caused by human error, design conflicts, and the unintended consequences of network change.

NetBrain accelerates the resolution of more than

95% of all network service tasks and prevents more than

50% of all network problems manifest themselves before they impact production.

¹ Source: Market Guide for Network Automation Tools | Published 22 February 2022

² Source: Network Management Megatrends 2022: Navigating Multi-Cloud, IoT, and NetDevOps During a Labor Shortage | April 2022 EMA Research Report

NetBrain Solves Your Most Common Problems

1. Proactive Troubleshooting

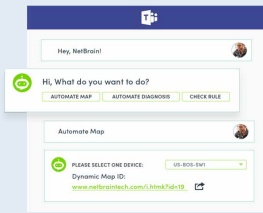

How NetBrain helps:

- Intent-based Maps allow collaboration and faster troubleshooting
- Integration with ITSM and network monitoring tools adds value by interpreting data for problem diagnosis
- Self-service ITSM, chatbot and email allow any support personnel to diagnosis problems using automation to collaborate from anywhere

Benefits:

- Improve NetOps productivity and efficiency
- Speeds problem solving with collaboration
- Reduces ticket hand-offs and escalations
- Ensures subject matter expertise is always available

2. Prevent Network Outages

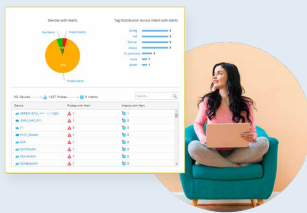

How NetBrain helps:

- Monitors network variable and configuration changes and automatically triggers intents to prevent the problems from occurring
- Proactively verifies the network is running as intended to achieve desired outcomes and maintain design compliance

Benefits:

- Enforces design rules and compliance at scale
- Maintains application performance by preventing configuration drift and human error
- Lowers operations cost by preventing recurring incidents and repetitive troubleshooting steps

3. Automated Application Assurance

Application	Source	Destination	Intent Result	History
			24 Alerts	12
			16 Alerts	8
			4 Alerts	2
			16 Alerts	4

How NetBrain helps:

- Supports the connectivity needs of all business applications and provides full visibility of the health of the network
- Automatically verifies and enforces every application traffic path against baseline topology, state, and condition for connectivity, performance, and security

Benefits:

- Reduce downtime and service degradations
- Maintain application performance requirements
- Prevent security issues like route leaks
- Diagnose transient path issues quickly

4. Protected Change Management

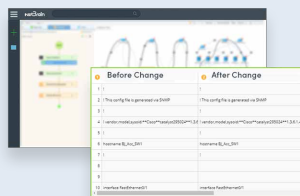

How NetBrain helps:

- Verifies network changes against network design and policies and benchmarks
- Enforces the existing network design rules
- Rollback quickly restores any previous configuration

Benefits:

- Assures compliance with network application and design intents
- Provides referenceable information for audits
- Safeguards the network from human error
- Speeds configuration updates

5. Continuous Network Assessment

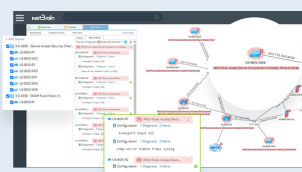

How NetBrain helps:

- Get in-depth network detail with contextual understanding of connectivity, performance, and security
- Create network assessment documents fast
- Digitize data and knowledge required for advanced assessment tasks
- Auto-create technology maps for follow-up

Benefits:

- Provides a comprehensive understanding of your network, fast
- Gives insight into where to safeguard the network
- Helps you uncover where you can optimize resources and reduce costs